

INKO21

+34 972 66 48 36

info@inko21.com

**inko21.com**

# SINGLE BEAM TROLLEY

## Use:

- as manually controlled trolleys for suspending BRANO hoists or hoists of other brands of the corresponding loading capacity
- for moving loads within the area of the crane track
- as part of the service hoists for installation and maintenance work in technological facilities of all types
- can also be used in environments with a risk of explosion ("NEXP")

## Characteristics:

- simple construction, with trolley adapting easily to the width of the crane track
- simple operation
- low maintenance requirements

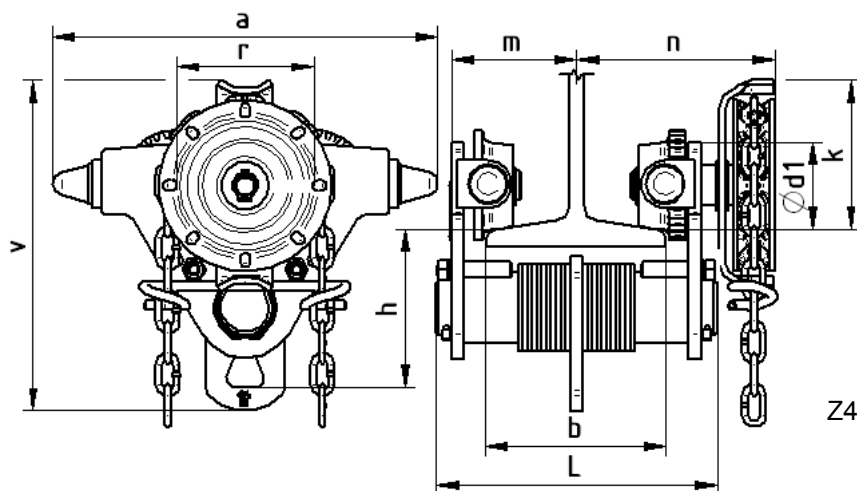

Z420-A, B, C/1t

Type	Lifting capacity (t)	Main dimensions (mm)									Beam (I, IPE, HEA, HEB, HEM)	
		a	h	L	v	d1	r	k	m	n	b	R
Z420-A	1 not suitable for profile HEM	245	100	178	209	55	87	95	52-80	99-126	50-113	1000
Z420-B				286					52-134	99-180	50-226	
Z420-C				372					90-177	136-223	125-300	
Z420R-A	1,6	245	100	178	177	55	87	63	52-80	–	50-113	1000
Z420R-B				286					52-134	–	50-226	
Z420-A	3,2	350	121,5	212	269	100	140	136	80-91	168-175	58-113	1700
Z420-B				324					80-145	168-230	58-226	
Z420-C				396					129-181	214-266	137-300	
Z420-A	5	435	134	239	309	133	170	162	86-97	178-189	82-125	2500
Z420-B				340					86-146	178-238	82-226	
Z420-C				414					113-183	205-275	160-300	
Z420-A	7,5	505	149	275	391	148	218	227	101-116	199-214	90-137	2800
Z420-B				364					101-162	199-260	90-226	
Z420-C				436					133-198	231-296	170-300	
Z420	10	685	248	415	432,5	196	300	222	150-186	294-330	125-185 (I)	5000
Z420-C				518					161-238	301-382	146-300 (I)	
Z420	10	765	278	448	503,5	228	328	256	160-193	306-339	125-185 (I)	9000
Z420-C				552					185-245	331-391	180-300 (I)	

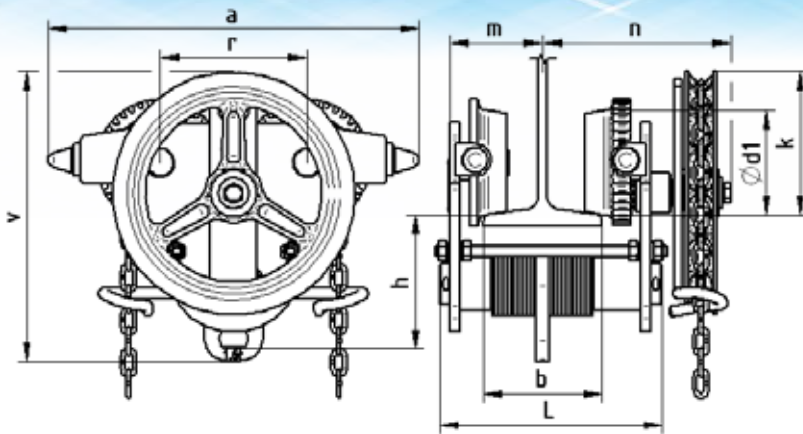

Z420R-A,B/1t

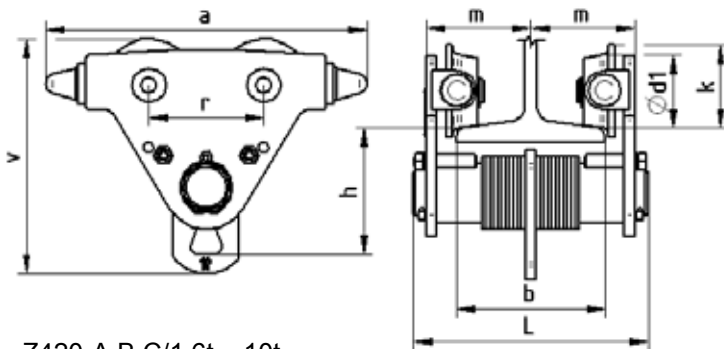

Z420-A,B,C/1,6t – 10t

**b** – range of flange width of a girder  
**R** – minimal curvature radius of trolley track

Type	Lifting capacity (t)	Operating force for travel ** (N)	Travel speed * (m/min)	Weight (kg)
Z420-A	1	250	4,8	8,7
Z420-B				10,4
Z420-C				11,4
Z420R-A	1,6	–	–	6,4
Z420R-B		–	–	78
Z420-A	3,2	150	2,25	21
Z420-B				22,8
Z420-C				24
Z420-A	5	280	2,3	35,9
Z420-B				37,8
Z420-C				39,5
Z420-A	7,5	350	1,8	52,9
Z420-B				54,7
Z420-C				58
Z420	10	500	5,97	124,2
Z420-C				128,2
Z420	10	500	7,3	179,5
Z420-C				187

\* Calculated on presumption of unwinding 30 m of hand chain per minute

\*\* At trolleys with lifting capacities 3,2 – 10t it is necessary when loading with loads approaching nominal lifting capacity to ensure the operation by two persons