

- **Automatic load-pressure brake**
- **Solid and galvanized housing**
- **Closed gear**

100 kg



Specification

The Winch SW 100 is characterised by a simple design. It is corrosion-proof **galvanized**, easy to run and can be used for all purposes. **Solid construction** via closed housing.

The SW 100 is equipped with an automatic axial load-pressure brake with safety catch which holds the load securely and safely in any position.

The gear is completely encapsulated. The bearing is equipped with **plain bearings** requiring no maintenance.

The crank is equipped with a turnable handle. The crank arm is **continuously adjustable** in length and can be **removed** in an unloaded condition.

The winch can be simply fixed to a wall or to a console. The winch is constructed in accordance with the Regulations for the Prevention of Accidents, BGV D8.

Delivered unit

Winch with crank. Supplied without fixing material or rope.

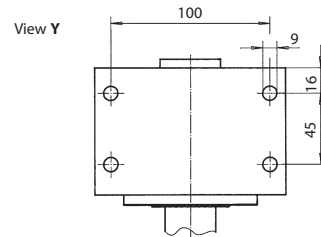
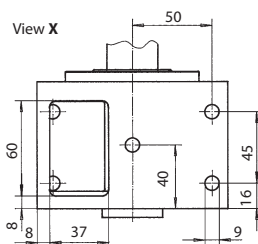
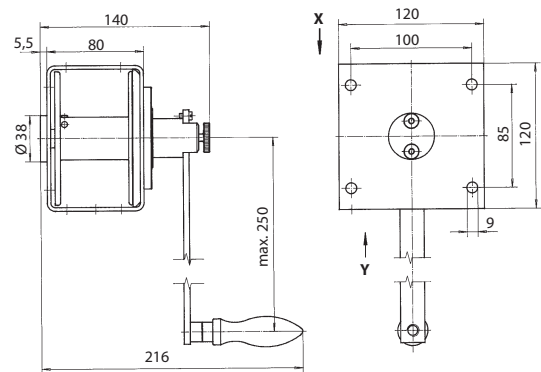

Order No.	Model	Pulling Force 1st Layer	Pulling Force 11th Layer	Minimum Load *	Manual Force	Rope Ø	Max Rope Capacity	Max Crank Radius	Average Stroke/Rotation	Weight
200 100	SW 100	100 kg	40 kg	15 kg	15 kg	3 mm	39 m	250 mm	200 mm	3 kg

* The winch must be operated with the indicated minimum load, otherwise the brake will not function.

Wire ropes on request.

650/3000 kg



Specification

The Winches SW 650, SW 1250 and SW 3000 are constructed with a **solid housing**. The equipment is completely galvanized. The winches are easy to run and can be used for all purposes.

The winches are equipped with an automatic radial **load-pressure brake**, which holds the load securely and safely in any position.

The brake operates in **both directions**; therefore, the rope can be wound from both sides. **Noise is kept to a minimum** due to the drum brake; no safety catch.

The gear is **completely encapsulated**. It is equipped with **plain bearings requiring no maintenance**.

The crank is equipped with a **turnable handle** and can be **removed** or **exchanged** even in a **loaded condition**.

The winches are equipped with a **direct drum drive** for rapid winding/unwinding of the unloaded rope.

The winch can be simply fixed to a console or to the floor.

The unwinding of the rope is possible in four directions. The winches are constructed in accordance with the Regulations for the Prevention of Accidents, BGV D8.

Delivered unit

Winch with crank. Supplied without fixing material or rope.

Order No.	Model	Pulling Force 1st Layer	Pulling Force Top Layer	Multipli-cation	Manual Force	Rope Ø	Max Rope Capacity	Crank Radius	Average Stroke/Rotation	Weight
200 200	SW 650	650 kg	250 kg	7:1	12 kg	6 mm	34 m	250 mm	40 mm	10 kg
200 300	SW 1250	1.250 kg	500 kg	13:1	15 kg	8 mm	80 m	400 mm	35 mm	30 kg
200 400	SW 3000	3.000 kg	1.500 kg	42:1	20 kg	12 mm	117 m	400 mm	20 mm	95 kg

Accessories and wire ropes on request.

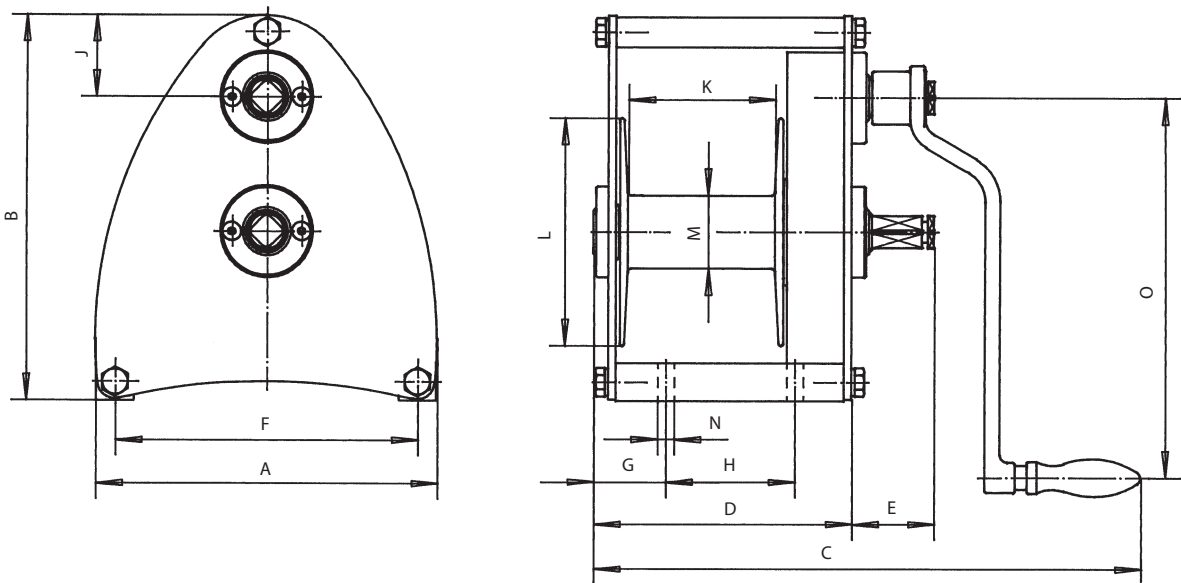

Dimension Model	A	B	C	D	E	F	G	H	J	K	L Ø	M Ø	N Ø	O
SW 650	226	254	362	170	55	200	48	85	54	97	150	48	11	250
SW 1250	370	402	492	263,5	55	330	53,5	170	79,5	166	238	76	13	400
SW 3000	526	575	593	363,5	56,5	470	63,5	250	155	220	345	127	18,5	400

MOTOR FOR MANUAL WINCH

- Worm drive to be fixed to WIMAG rope winches**
- Safety clutch operated by torque**
- Construction in accordance with the Regulations for the Prevention of Accidents**

Use motorised crank and not the manual crank and place it on the square spigot of the rope winch. It guarantees easy operation without force for large lifting heights.

The crank motor is equipped with a deadmans control as standard, guaranteeing maximum safety during lifting operation.

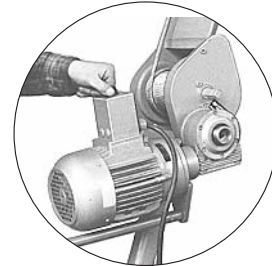

Order No.		206 100	206 200
Model		KM 1,1 D	KM 1,1 W
Type of Motor		Rotary Current	Alternating Current
Voltage	Volt	380	220
Frequency	Hz	50	50
Motor Power	kW	1,1	1,1
	Amp	2,6	5,1
Operating Time	% ED	40	100
Motor Speed	approx. min ¹	1400	1400
Gear Torque	Nm	125	125
Number of revolutions	min ¹	71	71
Protective System	IP	54	54
Weight	approx. kg	30	33

Delivery unit per motor:
5 m cable with CEE plug and
rod for torque.

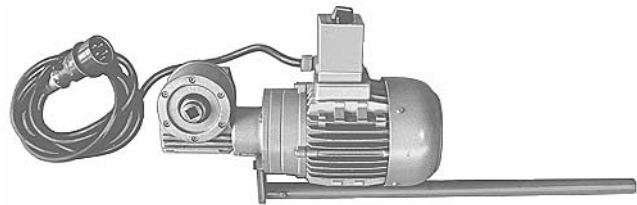

MOTOR FOR MANUAL WINCH

- Worm drive to be fixed to WIMAG rope winches**
- Safety clutch operated by torque**
- Construction in accordance with the Regulations for the Prevention of Accidents**

Use motorised crank and not the manual crank and place it on the square spigot of the rope winch. It guarantees easy operation without force for large lifting heights.

The crank motor is equipped with a deadmans control as standard, guaranteeing maximum safety during lifting operation.

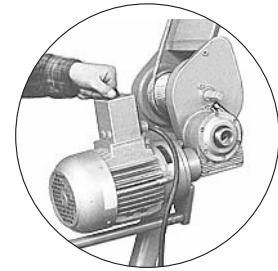

Delivery unit per motor:
5 m cable with CEE plug and
rod for torque.

Order No.		206 100	206 200
Model		KM 1,1 D	KM 1,1 W
Type of Motor		Rotary Current	Alternating Current
Voltage	Volt	380	220
Frequency	Hz	50	50
Motor Power	kW	1,1	1,1
	Amp	2,6	5,1
Operating Time	% ED	40	100
Motor Speed	approx. min ¹	1400	1400
Gear Torque	Nm	125	125
Number of revolutions	min ¹	71	71
Protective System	IP	54	54
Weight	approx. kg	30	33

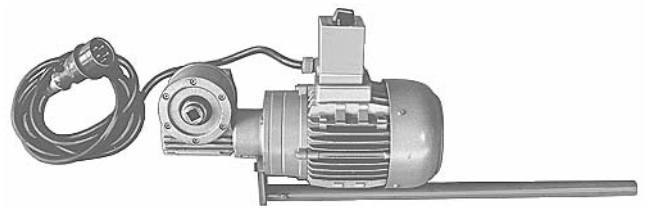

FLAT CLAMP

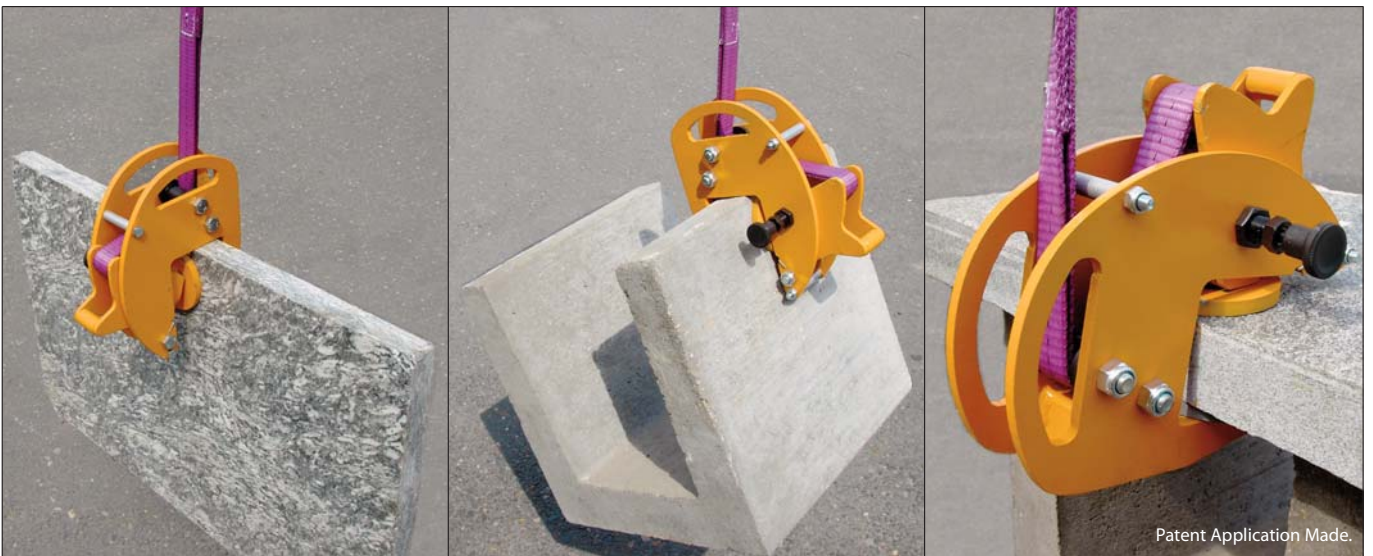

The clamp with the huge multiplication of 5:1 for the safe transport of plates.

- ❑ **Great safety** due to huge multiplication of 5:1.
- ❑ **Web sling** instead of chain/rope: low weight, no twisting, no injuries.
- ❑ The **narrow jaw** enables the putting down of upright plates or the erection of plates. Even tightly positioned upright plates can be gripped.
- ❑ No damage to the plate surface due to **rubber coating**.
- ❑ **Spring tension** prevents an inadvertent slipping down of the clamp.
- ❑ **Easy handling** by compact and convenient construction.
- ❑ Suitable for nearly **all materials**.

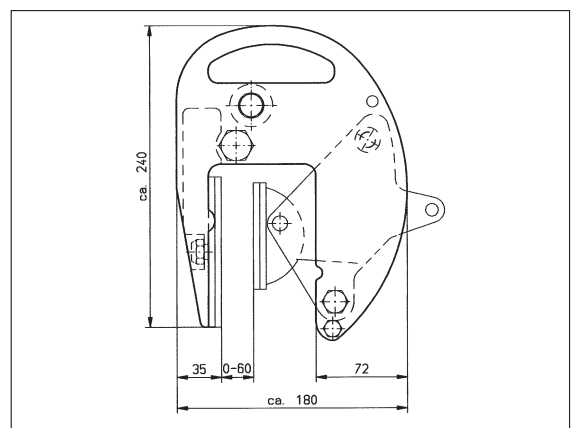

Order No.	Model	Carrying Capacity	Clamping Range	Weight
300 100	FZ 0,8	800 kg	0 - 60 mm	8 kg

BLOCK CLAMP



The clamp with the huge multiplication of 5:1 for the safe transport

- ❑ **Great safety** due to huge multiplication of 5:1.
- ❑ **Web sling** instead of chain/rope: light weight, no twisting, no injuries.
- ❑ Due to the **continuously adjustable suspension** also asymmetric elements can be handled in a horizontal position.
- ❑ The **narrow jaw** enables picking up of loads even when in confined spaces.
- ❑ Clamping jaws equipped with **rubber coating**.
- ❑ **Spring tension** prevents an inadvertent slipping down of the clamp.
- ❑ **Easy handling** by compact and convenient construction.
- ❑ Suitable for nearly **all materials**.

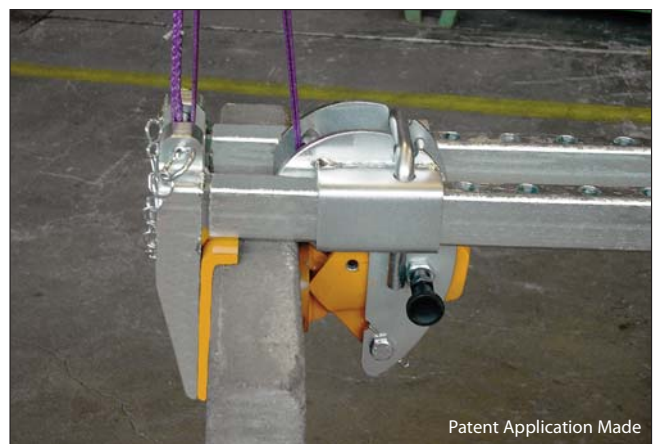

Order No.	Model	Carrying Capacity	Clamping Range	Weight
303 050	BZ 0,5-50	500 kg	10 - 500 mm	21 kg

CLAMP FOR UPRIGHT SLABS

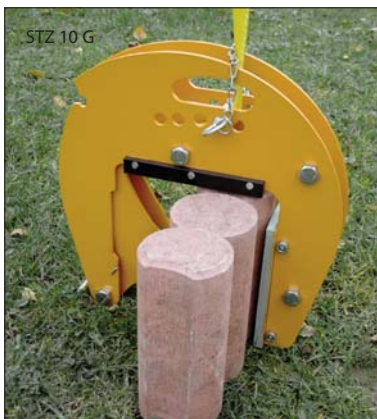
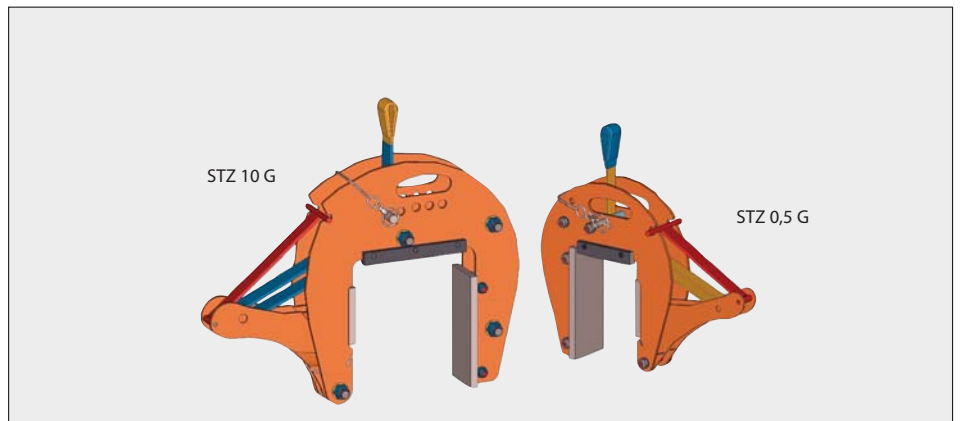

- Simple applying and disconnecting by means of holdfast application: clamp must not be lifted manually
- No adjustment of the clamping range
- Huge multiplication guarantees optimum safety
- Web sling instead of chain: light weight
- With spring tension
- Ideal for concrete and natural stones

Order No.	Model	Save Working Load kg	Typ Of Surface Coating	Clamping Range mm	Web Sling Length m	Weight kg
305 010	STZ 0,5	500	Serrated	40 - 120	0,25	8
305 011	STZ 0,5 G	500	Rubber-Lined	30 - 110	0,25	8
305 024	STZ 10	1.000	Serrated	100 - 225	0,25	14
305 025	STZ 10 G	1.000	Rubber-Lined	90 - 215	0,25	14

BORDER STONE LIFTER



LSH 80



LSH 80 with adapter 400



LSH 120

Application Made For Patent

- The ideal lifter for border stones according to DIN 483
- Ergonomic posture when lifting and laying the border stones
- Easy clamping and releasing by turning the handle
- Compact dimensions and low net weight

Order No.	Model	Safe Working Load kg	Contact Surface	Stone Thickness mm	Coating	Gewicht kg
307 080	LSH 80	80	Rubber-Lined	80	galvanized	2,5
307 080-1	LSH 80	80	Rubber-Lined	60 + 80	galvanized	2,7
307 120	LSH 120	80	Rubber-Lined	60 - 120	galvanized	3,0
307 200	Adapter set for plates 300 / 400 / 500 mm				galvanized	
307 260	Adapter for plates 600 mm				galvanized	

KERB STONE LIFTER



- For manual and machine hoisting operation
- Ideal for high and round kerb stones

- Galvanised construction

Order No.	Model	Carrying Capacity kg	Height of Kerb Stone mm	Width of Kerb Stone mm	Weight kg
308 100	BSH 140	140	max 300	150 / 180 / 200	5
308 102	BSH 140/S	140	max 400	80 - 150	6
308 110	BSH 120	140	max 300	80 - 120	5

SCREW CLAMP



- With rubber coating
- Galvanized construction
- ideal device for the transport and the laying of gravestones

Order No.	Model	Safe working load kg	Clamping range mm	Weight kg
309 050	SC 0,5-17	500	60 - 170	12
309 100	SC 1,0-26	1.000	70 - 260	20



- **Safe Transport of Concrete Parts via High Clamping Force**
- **Adjustable Suspension Ring for Balancing the Center of Gravity**

Flat Grab FG / FGB for the Safe Handling of Wide Loads.

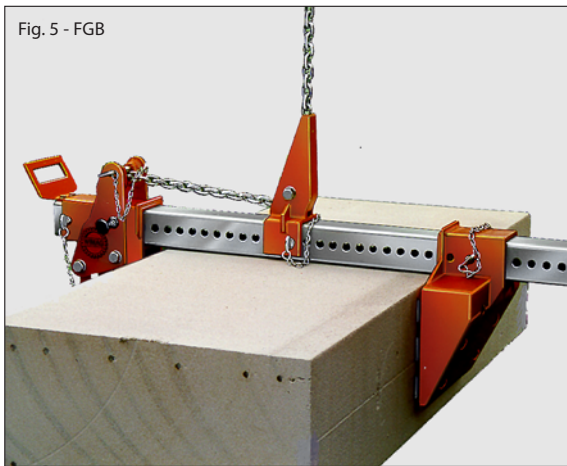

The Flat Grab FG was developed for the handling of rough stones and concrete parts with parallel surfaces.

High clamping force guarantees safe handling.

The complete clamping range of both clamping jaws is adjustable.

Due to the **adjustable suspension ring**, parts with an eccentric center of gravity can also be held in a horizontal position. The FG is equipped with exchangeable rubber coatings.

The Flat Grab FG can be used near to the ground with any lifting equipment.

For picking up the load, a bolt is pulled which snaps in by itself when the load is put down and the grab **opens automatically**.

Due to a high-strength chain the FG has a **low net weight**.

The model **FGB** has wide clamping jaws and is used for handling delicate parts.

The grab is coloured orange, RAL 2000. The beam and the connecting elements are galvanized.

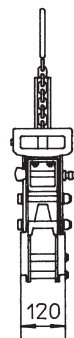
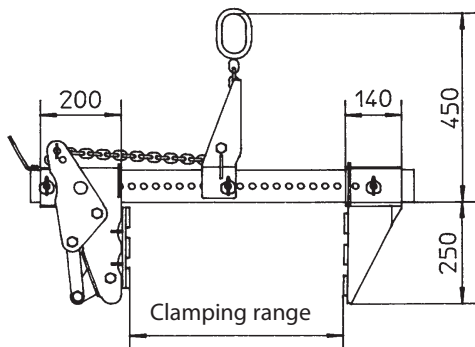

FG

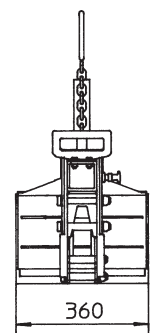

FGB

Order No.	Model	Carrying Capacity	Clamping Range	Jaw Width	Weight
315 050	FG 1,5-50	1.500 kg	30 - 500 mm	120 mm	40 kg
315 100	FG 1,5-100	1.500 kg	30 - 1.000 mm	120 mm	47 kg
315 150	FGB 1,5-50	1.500 kg	30 - 500 mm	360 mm	54 kg
315 200	FGB 1,5-100	1.500 kg	30 - 1.000 mm	360 mm	60 kg
315 994	Automatic FG/FGB				

Flat Grab FGS with Adjustable Suspension Ring for the Safe Handling of Concrete Parts.

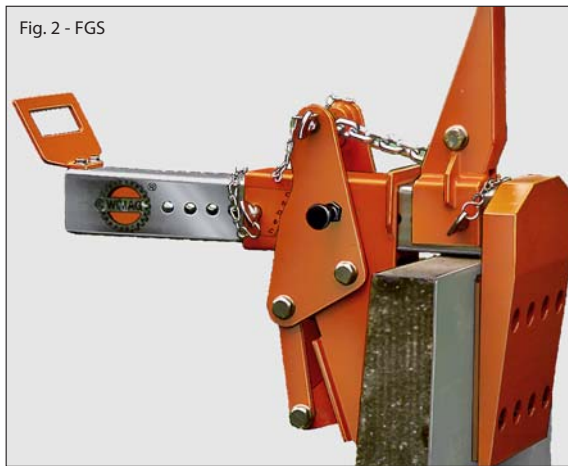

The Flat Grab FGS was developed for handling rough stones and concrete parts with parallel surfaces.

The high clamping force guarantees safe handling. One clamping jaw is adjustable. The narrow construction of the second clamping jaw is welded to one end of the beam. This narrow construction enables the grasping, tensioning and the safe **upright setting** of horizontally positioned concrete parts. Due to the **adjustable suspension ring**, e.g. L-shaped stones can be put into an upright position.

The FGS is equipped **with exchangeable rubber coatings**.



The FGS can be used near to the ground together with any lifting equipment.

For picking up the load, a bolt is pulled which snaps in by itself when the load is put down and the grab **opens automatically**.

Due to a high-strength chain the FGS has a **low net weight**. The guide handle enables an **exact positioning** of the load. The grab is coloured orange, RAL 2000. The beam and the connecting elements are galvanized. The application has been made for patent.

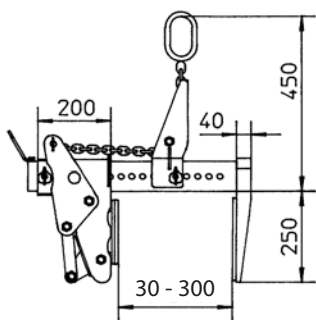

FGS 1,5-30

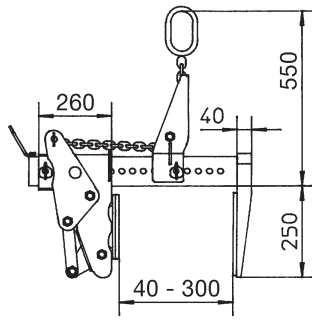

FGS 3-30

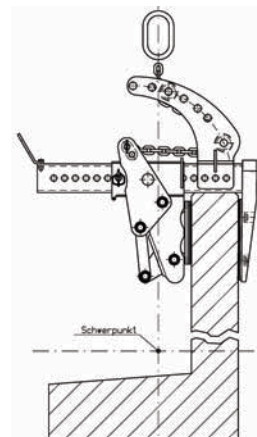

FGS with special suspension for L-shaped stones

Order No.	Model	Carrying Capacity	Clamping Range	Weight
315 030	FGS 1,5-30	1.500 kg	30 - 300 mm	47 kg
315 037	FGS 1,5-42	1.500 kg	30 - 420 mm	49 kg
315 035	Special suspension FGS 1,5			
315 994	Automatic FGS 1,5			
315 903	FGS 2,5-80	2.500 kg	40 - 800 mm	95 kg
315 040	FGS 3-30	3.000 kg	40 - 300 mm	81 kg
315 045	Special suspension FGS 3-30			
315 995	Automatic FGS 3			

Plate Grab for the Safe Handling of Horizontally Positioned Plates



Fig. 6 - PG

The Plate Grab PG was developed for handling rough plates with parallel surfaces. The high lever transmission guarantees **high clamping force**. By turning the clamping jaws, parts can also be gripped from the inside. The PG is equipped with exchangeable rubber coatings. The equipment is orange in colour, RAL 2000.

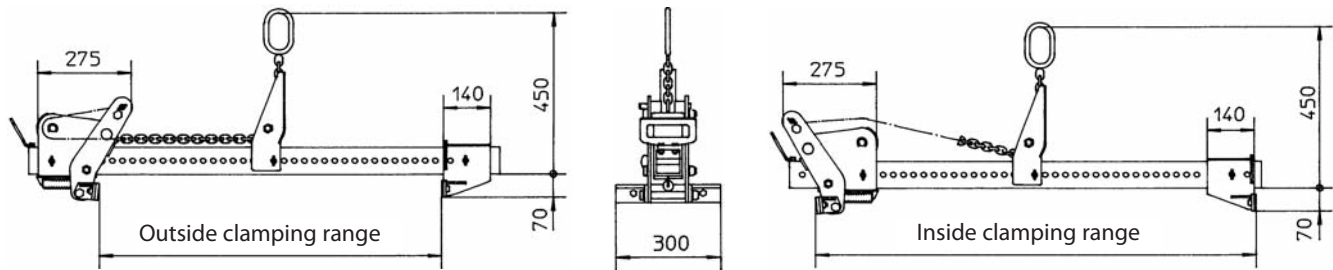

Order No.	Model	Carrying Capacity	Outside Clamping Range	Inside Clamping Range	Weight approx.
315 400	PG 1.5-100	1,500 kg	140 - 1,000 mm	450 - 1,350 mm	44 kg

Special Constructions

The Accident Prevention Regulation VBG 9a "Load-Handling Equipment for Hoisting System Service" requires a protective device for the operation of grabs **near to the ground** to prevent the load or parts of the load from falling down. The following special constructions have already been built:

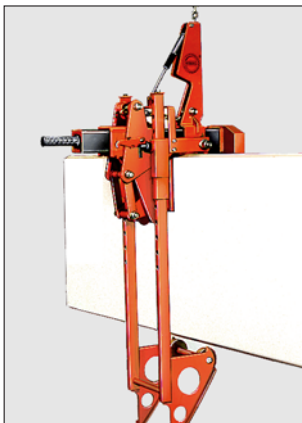

Flat Grab equipped with a catch hook for the laying of AAC wall panels near to the ground.



Flat Grab FGB-4.5-95 special construction, carrying capacity 4,500 kg clamping range 450-950 mm.

Enquire about our special constructions.

BOULDER GRAB



Boulder grab transporting irregular blocks.

- Large clamping range
- Adjustable suspension ring
- Large rotating range
- Large gripping depth
- Low weight

The ideal grab for heavy, irregular blocks.

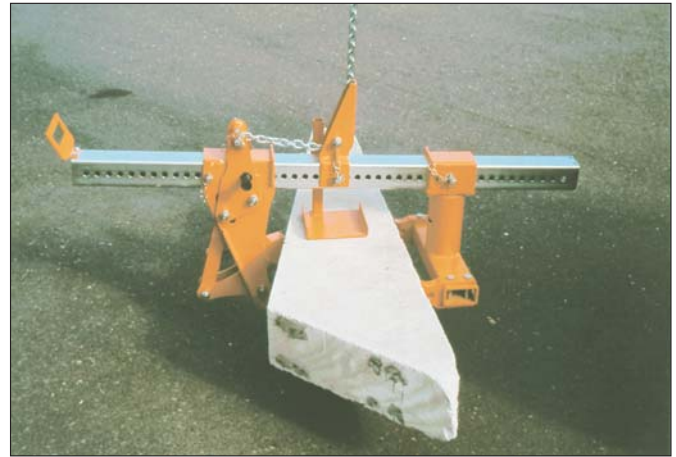

The boulder grab was developed for the simple transport of irregular stones and boulders. Of course, elements with parallel sides can also be transported.

The large lever transmission and the rotating clamping jaw guarantee a stable load handling. The roughly profiled clamping jaws ensure a safe gripping. The clamping jaws can be replaced by hardened tips.

The holding down device is adjustable in height.

When handling asymmetrical loads with an eccentric center of gravity the suspension eye can be exactly positioned above the center of gravity. The clamping jaws can be adjusted on both sides via bolts.

The boulder grab can be used with any material handling lifting equipment near to the ground. Remove bolt when picking up the load. When setting down the load the bolt will snap in by itself and the grab opens automatically.

Paint: orange, RAL 2000; beam and joining elements are galvanized.

Application made for patent.

Specification

Clamping range	0 - 920 mm	Total length	approx. 1,500 mm
Rotating range	on both sides approx. 15°	Total width	approx. 470 mm
Gripping depth	approx. 250 mm	Total height	650 mm

Order No.	Model	Carrying Capacity kg	Clamping Range * mm	Weight kg
316 500	STG 1-100	1.000	0 - 920	91
316 502	STG 1,5-100	1.500	0 - 920	96

* for parallel sides

Special designs upon inquiry.

330

WALL PANEL LIFTING GEAR

The galvanized wall panel lifting gear is used for the laying of horizontally positioned AAC wall panels. The profiled clamps ensure a high grip. If the safety chain is applied a transport high above the ground is permitted. The safety chain can be released by a tension rope of 10 m length.

Order No.	Model	Carrying Capacity kg	L mm	Span B mm	H mm	Weight kg
330 010	PIZa 1	675	520	70 - 230	285	43
330 020	PIZa 2	1.000	660	150 - 310	330	50
330 040	PIZa 4	1.400	1.000	150 - 310	330	65

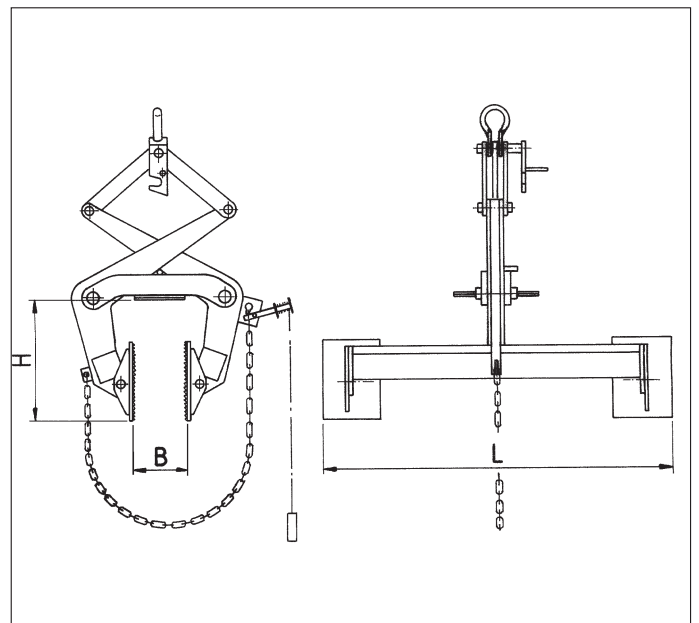

346

JUMBO BLOCK PINCER

The jumbo block pincer is used for the laying of AAC jumbo stones. The steel teeth of the clamps enable a high grip. The working width can be adjusted using the bolt supplied. Cream-coloured varnish, RAL 9001.

Order No.	Model	Carrying Capacity kg	Span cm	Width mm	Weight kg
346 010	JZ 2,5	250	11,5 / 15 / 17,5 / 20 / 25 / 30 / 36,5	50	7

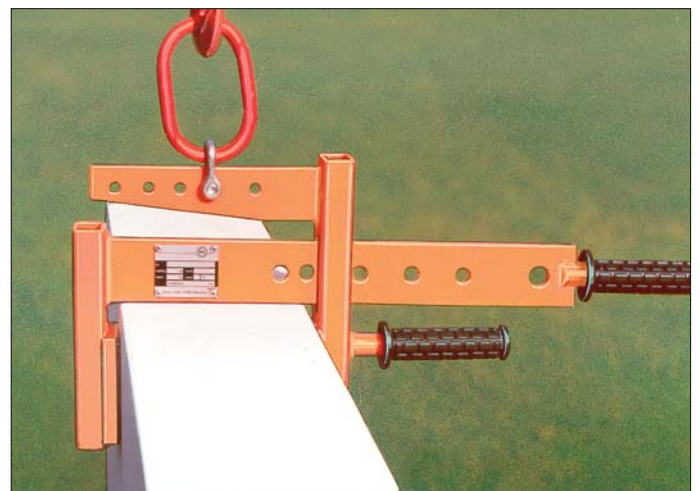

350

FLOOR PANEL LIFTING GEAR

Floor panel lifting gear with safety chain.

This lifting gear is used for the laying of reinforced floor and roof panels with profiled sides.

The panels can be laid by one person without any space left in between. Adjustment of the panels is not necessary.

The floor panel lifting gear is delivered with a chain storage and 2 galvanized safety chains which can be continuously fitted. The chains are fixed and as a result cannot be lost.

If the safety chains is applied a transport high above the ground is permitted.

Order No.	Model	Carrying Capacity kg	L* mm	Span mm	H** mm	Weight kg
350 030	DeVeZa 3	800	1.000	250 - 750	100	80
350 040	DeVeZa 4	1.400	2.000	250 - 750	100	150

* L = Construction length / ** H = Profile height (see Fig.)

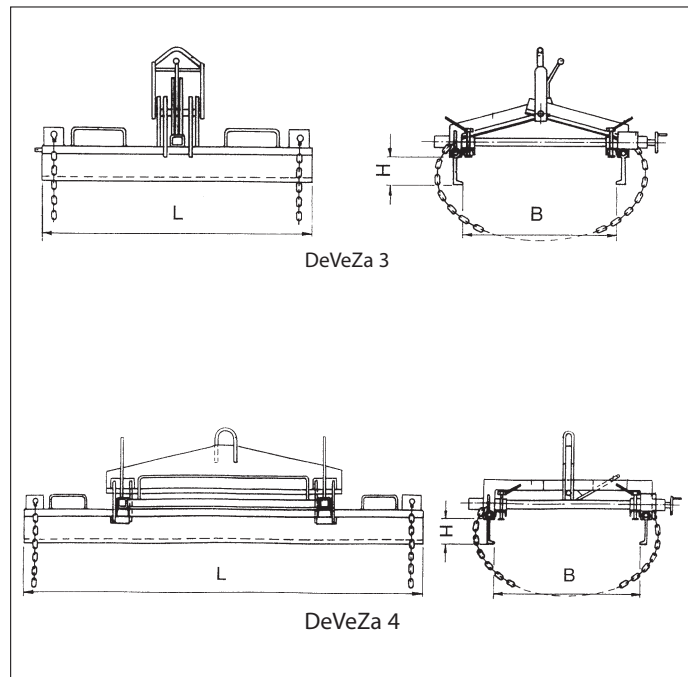

SPECIAL DESIGNS



Floor panel lifting gear with catch hook for the transport high above the ground.



Flat grab FG/U with catch hook for the safe erection of wall panels, to be carried out also high above the ground.

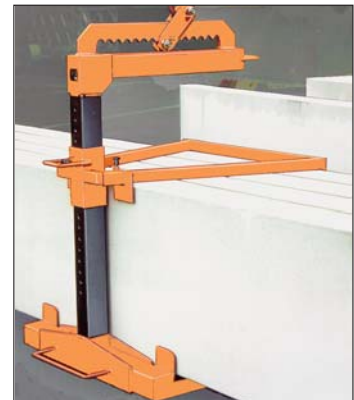

Off loading yoke for panels AbBü 3.4 for the transport of vertically positioned panels and packages.

GUTTER STONE CLAMP



- The ideal clamp for gutter stones, block steps, ...
- Equipped with milled tooth strips and handle grips
- Galvanized as standard

Order No.	Model	Safe Working Load kg	Clamping Range mm	Weight kg
346 047	Gutter stone clamp RSZ 1	100	310 / 350 / 500	7

STONE CLAMP

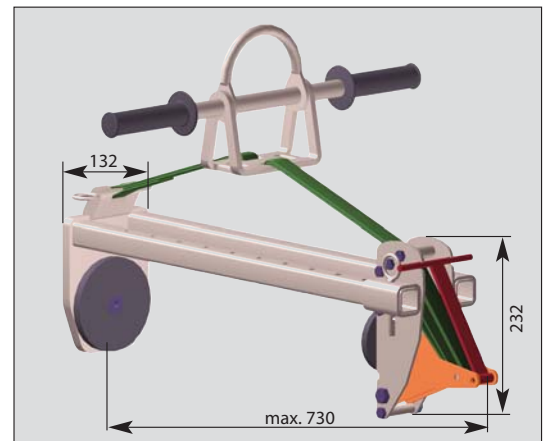

- Ideal for concrete stones and plates
- For manual and machine hoisting operation
- Huge multiplication guarantees great safety
- Web sling instead of chain: light weight
- Continuously adjustable suspension, rotateable horizontally through 90°

- Large clamping range
- Equipped with spring tension
- Clamping jaws equipped with rubber coating
- Galvanized construction

Order No.	Model	Safe Working Load	Clamping Range	Weight
380 050	SZ 0,25-50	250 kg	10 - 500 mm	11 kg
380 100	SZ 0,25-100	250 kg	10 - 1.000 mm	14 kg

STONE LIFTER



SH 40 for kerb stones, stones, boulders

- With rubber coating or tips
- For manual and machine operation near to the ground
- Also suited for curved kerb stones
- Galvanized construction

Order No.	Model	Safe Working Load	Stone Length, Stone Width	Weight
382 040	SH 40	200 kg	0 - 400 mm	9 kg
047 886	Stone tip for SH 40 (3 pieces are needed)			

HOLLOW BLOCK CLAMP



- With rubber coating
- Galvanized construction
- For manual and machine operation near to the ground

Order No.	Model	Safe Working Load kg	Clamping Range mm	Weight kg
383 200	FSZ 0,2	200	150 - 600	10

LIFTING BEAM

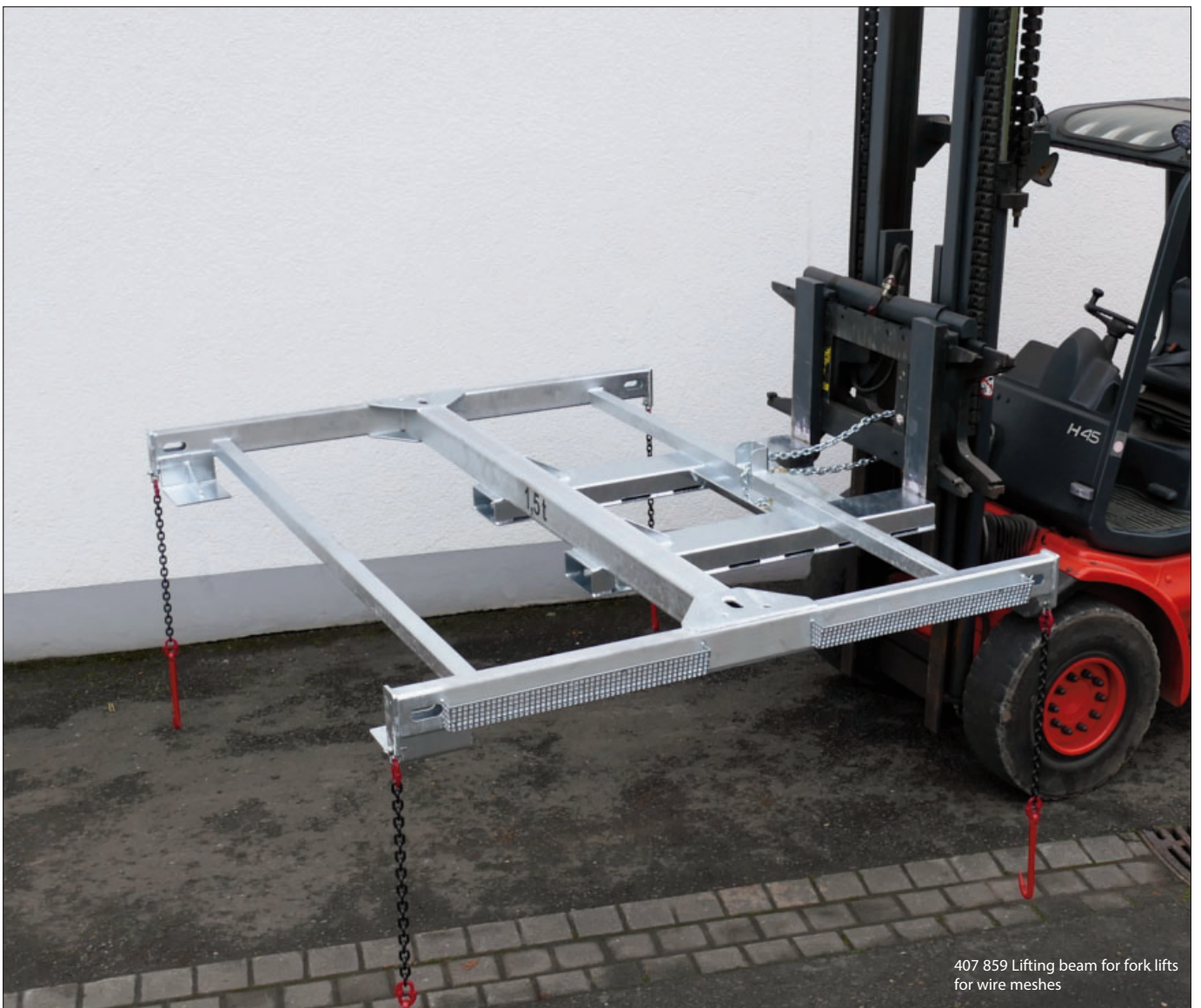

407 859 Lifting beam for fork lifts
for wire meshes

- ❑ Lifting beams made of light steel construction
- ❑ Custom-made lifting beams for all applications
- ❑ Construction according EN 13155

Static Lifting Beams - TS

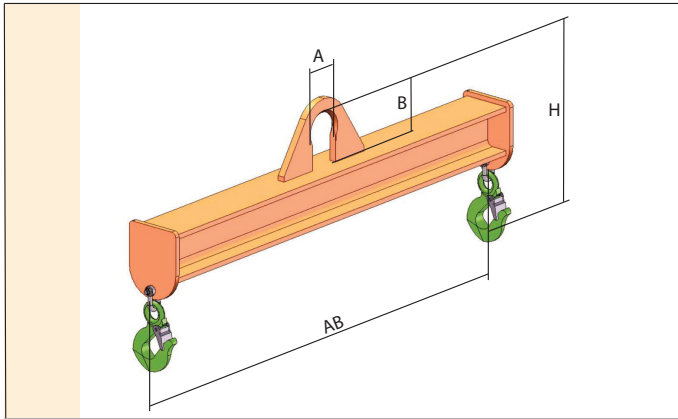

Adjustable Lifting Beams - TV

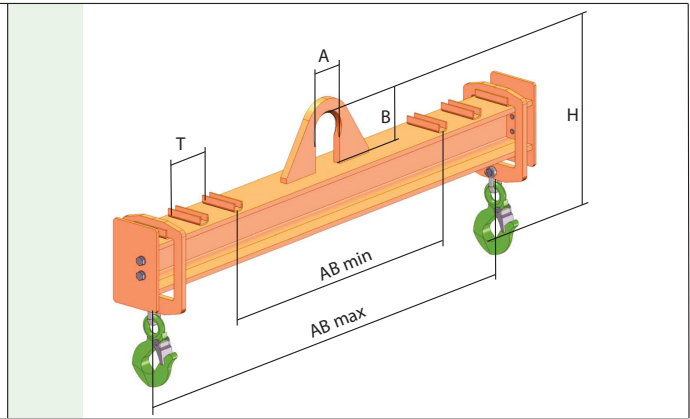

Order No.	Model	Safe Working Load kg	Working Width AB min/max mm	Section T mm	Total Height H mm	Suspension Eye A x B mm	Weight kg
405 061	TS 1/2	1,000	2,000		340	70 x 110	40
405 071	TS 1/3	1,000	3,000		340	70 x 110	60
405 081	TS 1/5	1,000	5,000		380	70 x 110	140
405 101	TS 3/2	3,000	2,000		430	90 x 140	80
405 111	TS 3/3	3,000	3,000		450	90 x 140	140
405 121	TS 3/5	3,000	5,000		470	90 x 140	280
405 141	TS 5/2	5,000	2,000		480	90 x 140	105
405 151	TS 5/3	5,000	3,000		500	90 x 140	160
405 161	TS 5/5	5,000	5,000		540	90 x 140	380
405 065	TV 1/2	1,000	1,000 / 2,000	125	340	70 x 110	45
405 075	TV 1/3	1,000	1,000 / 3,000	125	340	70 x 110	65
405 085	TV 1/5	1,000	1,000 / 5,000	250	380	70 x 110	150
405 105	TV 3/2	3,000	1,000 / 2,000	125	495	90 x 140	100
405 115	TV 3/3	3,000	1,000 / 3,000	125	500	90 x 140	150
405 125	TV 3/5	3,000	1,000 / 5,000	250	520	90 x 140	310
405 145	TV 5/2	5,000	1,000 / 2,000	125	550	90 x 140	120
405 155	TV 5/3	5,000	1,000 / 3,000	125	575	90 x 140	200
405 165	TV 5/5	5,000	1,000 / 5,000	250	620	90 x 140	405

Alternative dimensions/safe working loads available on request. I Dimensions subject to change.

Lifting Beam For Fork Lifts

Order No.	Model	Safe Working Load kg	Weight kg
405 550	STS-3.0-0.65	3,000	22

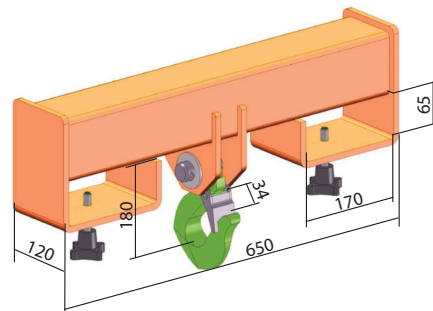

Suspension

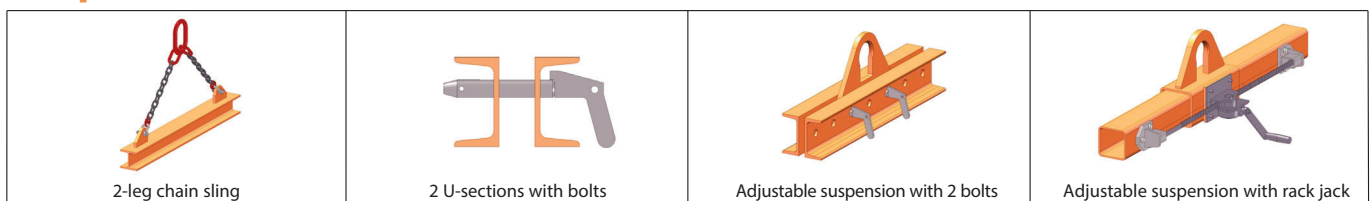

Load Attachment

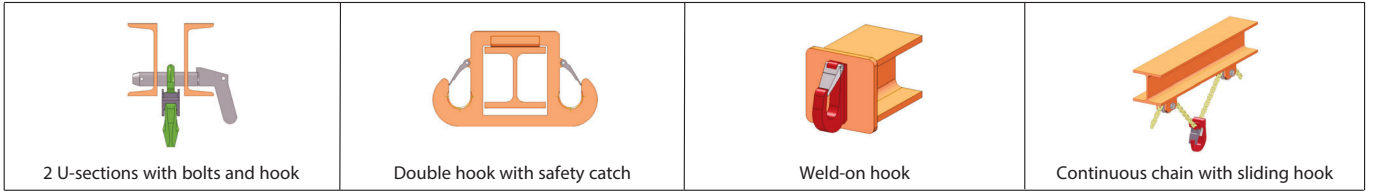

Accessories

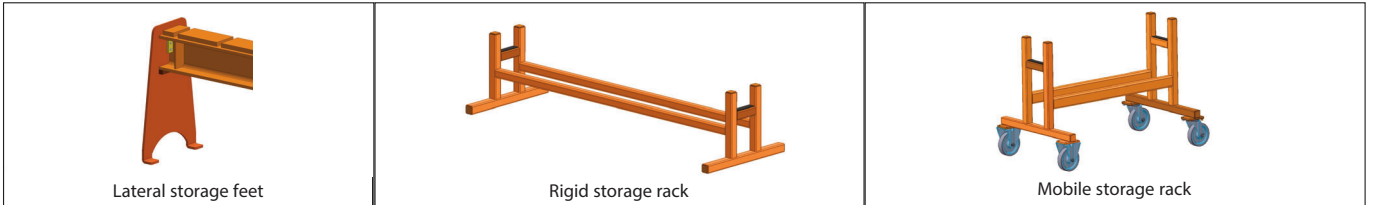

Special Designs

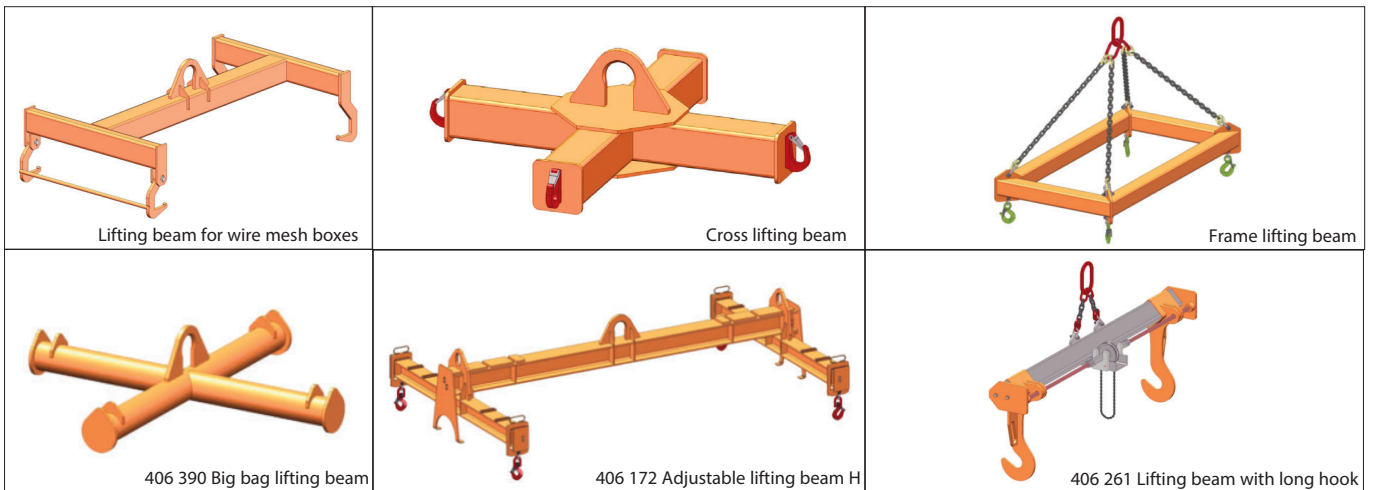



407 872 Grab for wire meshes



407 756 Lifting beam for containers



407 855 Rotatable lifting beam



407 972 Adjustable Lifting beam H

ALUMINIUM LIFTING BEAM



Aluminium Lifting Beam rigid with hooks on both faces

2 guide handles
Aluminium profile
Steel rigging equipment
Coated in orange

Order No.	Model	Carrying Capacity kg	Working Width mm	Total Construction Height mm	Suspension Eye mm	Weight kg
410 051	ATS 0.5-1	500	1,000	180 / 280	70 x 90	10
410 052	ATS 0.5-2	500	2,000	180 / 280	70 x 90	15
410 053	ATS 0.5-3	500	3,000	180 / 280	70 x 90	19
410 152	ATS 1.5-2	1,500	2,000	280 / 380	70 x 90	23
410 153	ATS 1.5-3	1,500	3,000	280 / 380	70 x 90	29
410 154	ATS 1.5-4	1,500	4,000	280 / 380	70 x 90	35



Aluminium Lifting Beam adjustable with 2 hooks

2 guide handles
Aluminium profile
Steel rigging equipment
Coated in orange

Order No.	Model	Carrying Capacity kg	Working Width min / max mm	Hole intervals mm	Total Construction Height mm	Suspension Eye mm	Weight kg
410 251	ATV 0.5-1	500	500 / 1,000	125	285 / 345	70 x 90	14
410 252	ATV 0.5-2	500	500 / 2,000	125	285 / 345	70 x 90	18
410 253	ATV 0.5-3	500	1,000 / 3,000	125	285 / 345	70 x 90	23
410 352	ATV 1.5-2	1,500	1,000 / 2,000	125	385 / 445	70 x 90	28
410 353	ATV 1.5-3	1,500	1,000 / 3,000	125	385 / 445	70 x 90	34
410 354	ATV 1.5-4	1,500	1,000 / 4,000	250	385 / 445	70 x 90	40

Aluminium Lifting Beam H rigid

with hooks on both faces

4 guide handles
Aluminium profiles
Steel rigging equipment
Coated in orange



Order No.	Model	Carrying Capacity kg	Working Length mm	Working Width mm	Total Construction Height mm	Suspension Eye mm	Weight kg
410 451	AHTS 0.5-1-1	500	1,000	1,000	80 / 305	70 x 90	32
410 452	AHTS 0.5-2-1	500	2,000	1,000	80 / 305	70 x 90	36
410 453	AHTS 0.5-3-2	500	3,000	2,000	80 / 305	70 x 90	49
410 552	AHTS 1.5-2-1	1,500	2,000	1,000	80 / 405	70 x 90	45
410 553	AHTS 1.5-3-2	1,500	3,000	2,000	80 / 405	70 x 90	60
410 554	AHTS 1.5-4-2	1,500	4,000	2,000	80 / 405	70 x 90	66

Aluminium Lifting Beam H adjustable

with 4 adjustable hooks

4 guide handles
Aluminium profiles
Steel rigging equipment
Coated in orange



Order No.	Model	Carrying Capacity kg	Working Length mm	Working Width mm	Teilung mm	Total Construction Height mm	Suspension Eye mm	Weight kg
410 651	AHTV 0.5-1-1	500	500 / 1,000	500 / 1,000	125	185 / 305	70 x 90	33
410 652	AHTV 0.5-2-1	500	500 / 2,000	500 / 1,000	125	185 / 305	70 x 90	37
410 653	AHTV 0.5-3-2	500	1,000 / 3,000	500 / 2,000	125	185 / 305	70 x 90	50
410 752	AHTV 1.5-2-1	1,500	1,000 / 2,000	500 / 1,000	125	185 / 405	70 x 90	46
410 753	AHTV 1.5-3-2	1,500	1,000 / 3,000	500 / 2,000	125	185 / 405	70 x 90	61
410 754	AHTV 1.5-4-2	1,500	1,000 / 4,000	500 / 2,000	250	185 / 405	70 x 90	67

LOAD ROTATING BEAM



422 120-5 WTVE 0,2/2,0

- Safe rotating of even eccentric loads
- Manual or electric operation
- Stable suspension due to a 2-leg sling
- Endless slings with a circumference of 3 m

Everyone is aware of the problems of rotating and positioning bulky loads.

To solve the problem we offer 2 types of load rotating beams: manual or electric operation.

The **manually operated** load rotating beams are rotated by a hand chain. The worm gear is self-locking. The chain is designed for 2 m operating height. The load rotating beams are delivered with endless slings of 3 m circumference. Other circumferences on request.

Order No.	Model	Carrying Capacity kg	Working Width Approx. mm		Construction Height Approx. mm		Torque Max. Nm	Weight Approx. kg
			Min.	Max.	Min.	Max.		
422 015	WTV-1.5/1.5	1,500	500	1,500	1,160	930	200	78
422 020	WTV-1.5/2.0	1,500	500	2,000	1,510	1,180	200	83

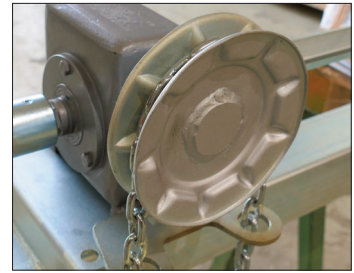

The **electrically operated** load rotating beam rotates the load by a self-locking worm gear using a pendant control.

The length of the control cable is 3 m and the feeding cable with CEE plug is 5 m long. Electric motor: rotary current 400 V - 50 Hz, 30% ED, 0,3 kW, protective system IP 54, control voltage 24 V.

The circumference of the endless slings is 3 m. Other circumferences available upon request. Model WTVE is also available with remote control.



Order No.	Model	Carrying Capacity kg	Working Width Approx. mm		Construction Height Approx. mm		Torque Max. Nm	Weight Approx. kg
			Min.	Max.	Min.	Max.		
422 115	WTVE-1.5/1.5	1,500	750	1,500	1,140	930	600	100
422 120	WTVE-1.5/2.0	1,500	750	2,000	1,500	1,180	600	134

422 020 WTV-1.5/2.0

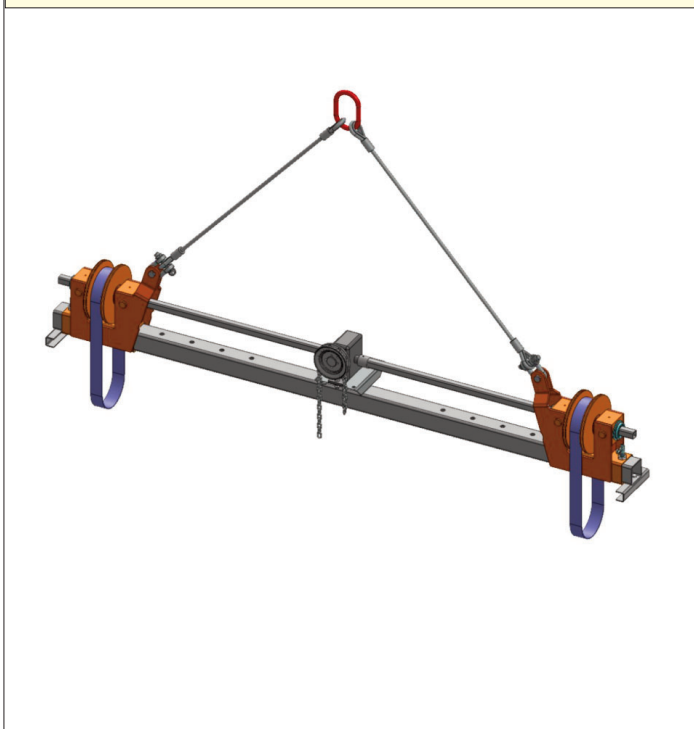

422 120 WTVE-1.5/2.0

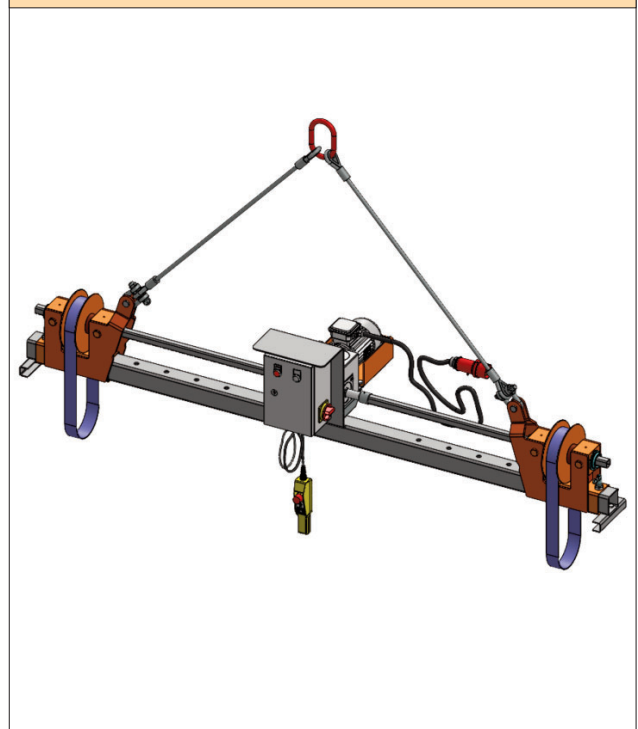

SPECIAL DESIGNS



422 020 WTV 1.5/2.0



422 667 WTVE 1.5/2.0 with suspension eye and special paint



422 663 WTVE 10/5: Carrying capacity 10 t, working width min./max. 1,500/5,000 mm, electrically adjustable, with remote control

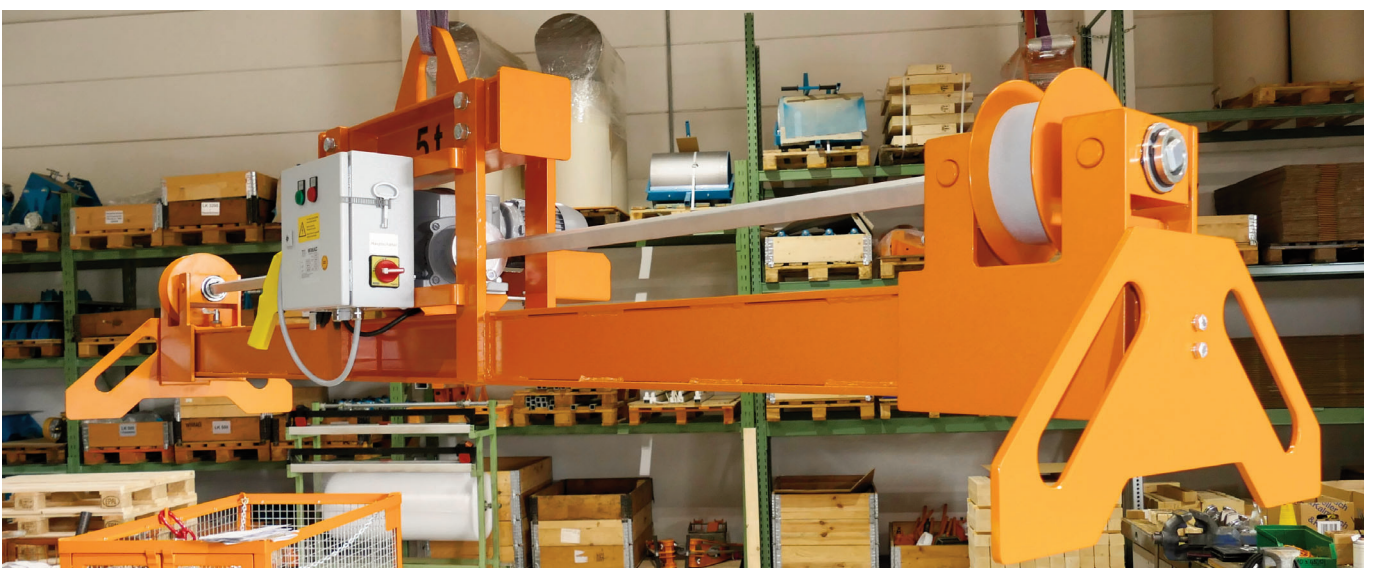

422 638 WTVE 5/3: Carrying capacity 5 t, working width, rigid, 3.000 mm

SPECIAL DESIGNS



422 620 WTVE 2/2: Carrying capacity 2 t, working width min./max. 500/2,000 mm, adjustable with bolts, with counter weight



422 584 / 422 585: Load rotating device WTE 2.0 with load rotating drum WT 1.0, total carrying capacity 3 t



422 556: Two load rotating devices WG 12.5, with distance frame, total carrying capacity 25 t

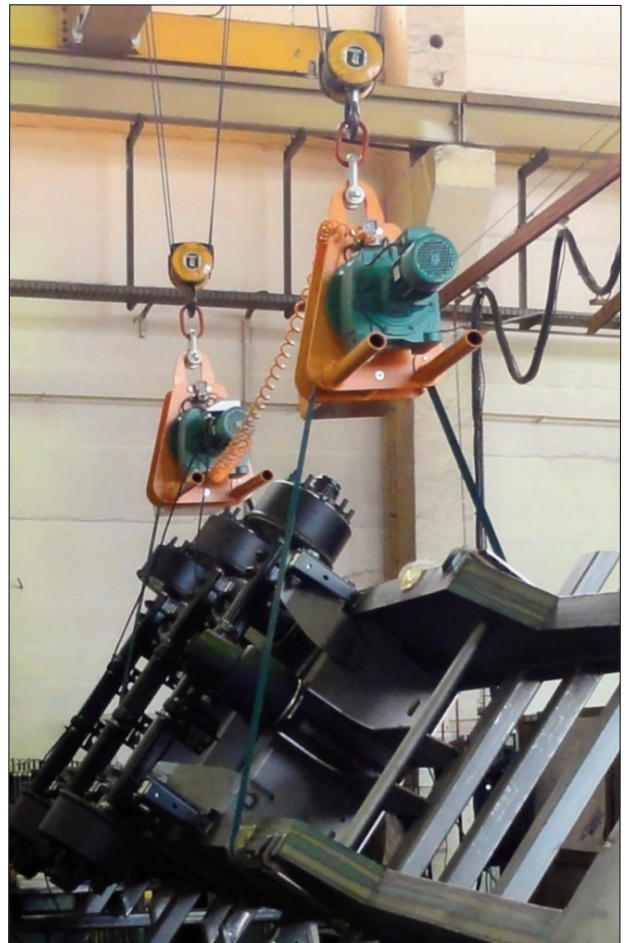

422 592: Two load rotating devices WG 4, total carrying capacity 8 t

PALLET LIFTER PH

When using a standard fork lift you will need 4 load cycles for load lifting as well as for setting down of the load:

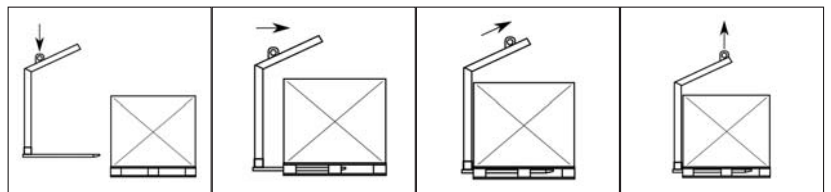

- The pallet lifter PH reduces the load cycles by 50%.
- The ideal material handling equipment for building construction

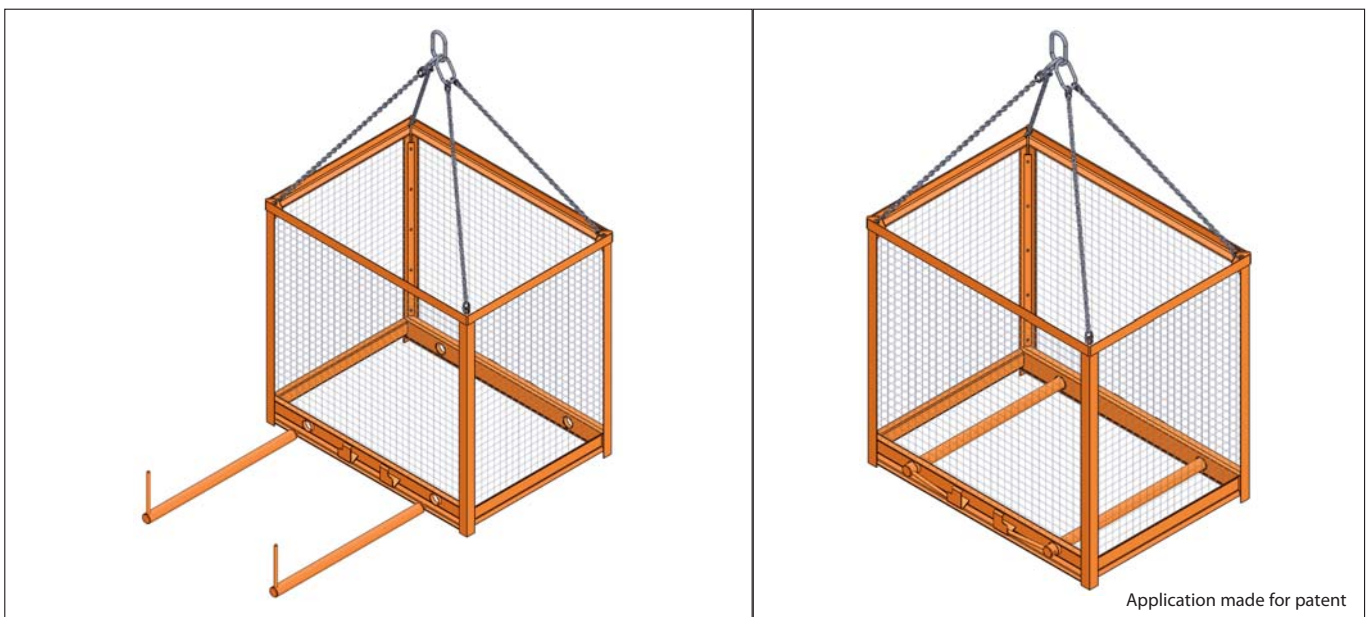

- Load handling equipment and protective cage in one equipment
- Complies with requirements of EN 13155 for use on construction sites
- Manual picking up of the Euro-Pallet via 2 bolts

Order No.	Model	Carrying Capacity	Length x Width x Height	Weight
450 100	Pallet Lifter PH	1,500 kg	1,304 x 964 x 2,250 mm	96 kg

PALLET LIFTER PHA

When using a standard fork lift you will need 4 load cycles for load lifting as well as for setting down of the load:

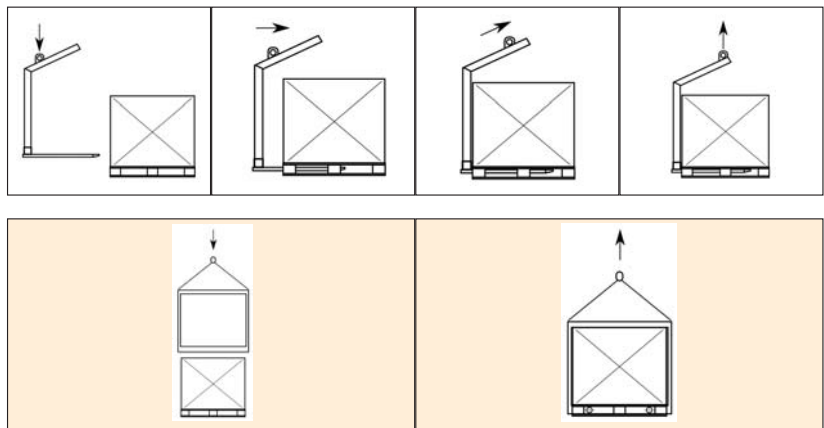

- The automatic pallet lifter PHA reduces the load cycles by 50%.
- The ideal material handling equipment for building construction

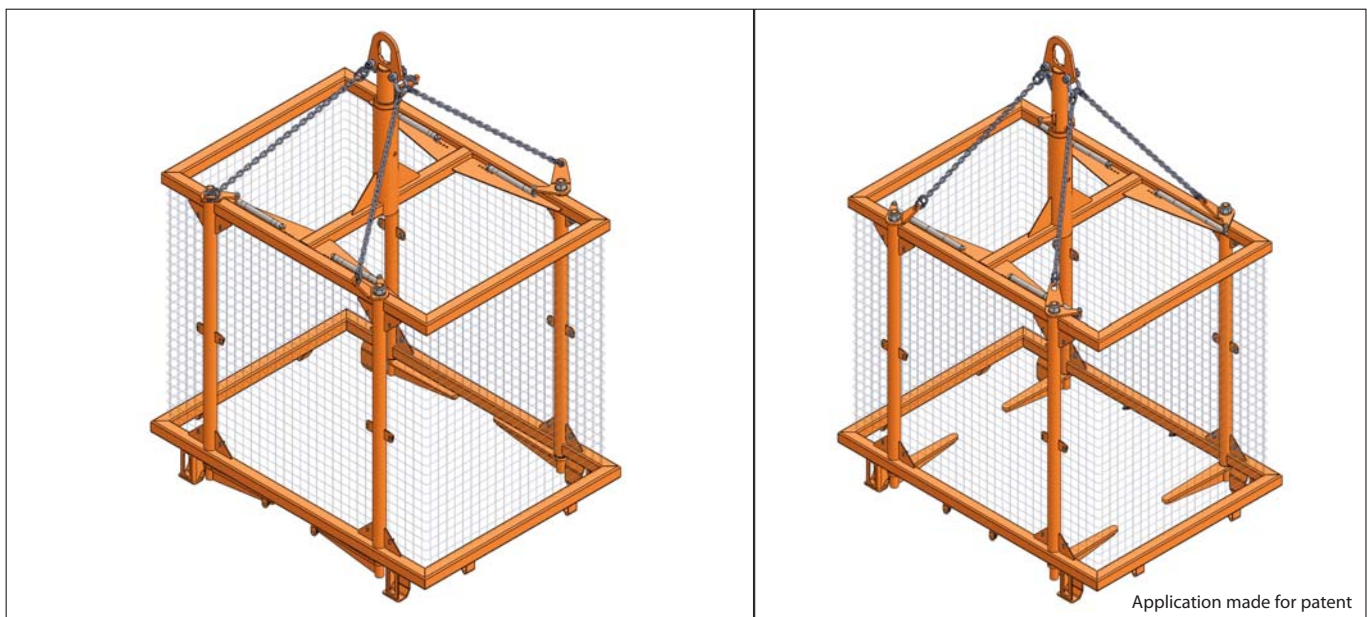

- Load handling equipment and protective cage in one equipment
- Complies with requirements of EN 13155 for use on construction sites
- Picking up with a rotatable fork due to a lifting/lowering automatic system

Order No.	Model	Carrying Capacity	Length x Width x Height	Weight
451 100	Pallet Lifter PHA	1,500 kg	1,345 x 978 x 2,050 mm	160 kg
451 101	Adapter for rotator			